

COLOR WAVE

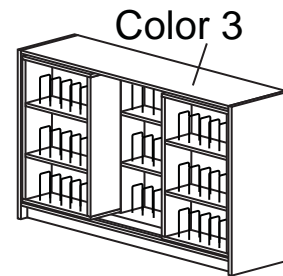

Shown with Tendu 3MT08 laminate on color 1 (lower face) and Nubian Brown 4MF91 on colors 2 and 3, (upper cabinet, back splash, lower top and sides).

COLOR WAVE

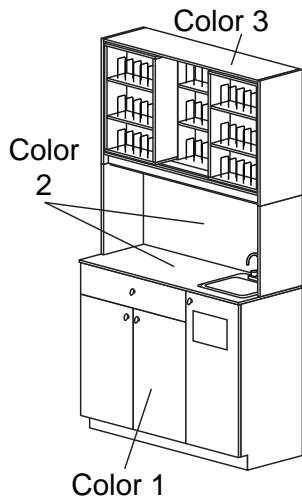

Model	CWB62-HPL	CWB61-HPL
	Complete color storage system	Wall hung color storage
Specify Group 1 Pulls		
Specifications		
Shipping Weight	248	70
Width	48	32
Depth	24	24
Height	78	32
Specify Colors	1. Main: upper & lower cabinet	1. Main:
Features	<p>Complete color storage system features 2 overhead sliding modules that provide greatly increased storage for color products, overhead storage with steel divider rods available in configurations for major brands of professional hair color. Adjustable wire dividers allow customer to customize cabinet for different size boxes. Capacity for boxes of a maximum width of 1.72" x 7" length holds 600 color tubes, 8 rows per section with 15 sections for storage. Capacity for boxes of a maximum width of 2.17" x 7" length holds 396 color tubes, 6 rows per section with 15 sections for storage.</p>	
	<p>Inset sink is 15" x 15", bowl size is 10" wide x 12" long x 5" deep. Depth with a goose neck fixture. Towel drop area built in front of cabinet for easy access, 6" high by 10" wide.</p>	