



# PRODUCT SPECIFICATION SHEET

**Part #:** 462-33

**Description:** Reve Wall-Mounted Styling Station

**Standard Features:**

- 1 Full extension drawer for shears, combs, & brushes
- Countertop holders for blow dryer, flat iron, & curling iron
- No visible hardware
- 30"W x 48" mirror w/ twin accent panels
- 
- 
- 
- 
- 

*Eight Color Choices: Black, Shaker Cherry, Cafelle, Fusion Maple, Limber Maple Wild Cherry, Brighton Walnut, Graphite Nebula*



*(Forty additional choices available for 10% upcharge)*

**Specifications:**

Reve Wall-Mounted Styling Station w/ full-extension drawer for shears, combs, and brushes, holders and holders for blow dryer, flat iron and curling iron. Includes 30" x 48" mirror with accent panels. 33"W x 15"D x 5"H x 53"H.

**Optional Features:**

- Cam lock
- 
- 
- 

**Shipping and Assembly/Installation Information**

Assembly Required:	<input checked="" type="checkbox"/>	Yes	<input type="checkbox"/>	No
Electrical Required:	<input type="checkbox"/>	Yes	<input checked="" type="checkbox"/>	No
Plumbing Required:	<input type="checkbox"/>	Yes	<input checked="" type="checkbox"/>	No
Ship Dimensions	32	"W x 48	"D x 42	"H
Total Ship Weight	98	LBS		
# of Ship Pieces		Cartons	1	Skids

**Additional Information:**

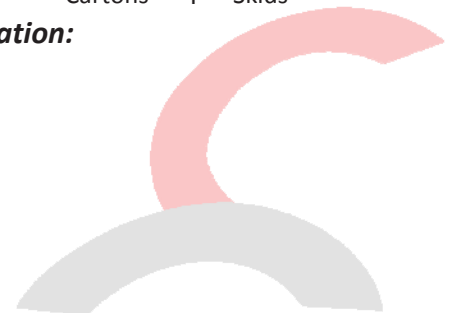
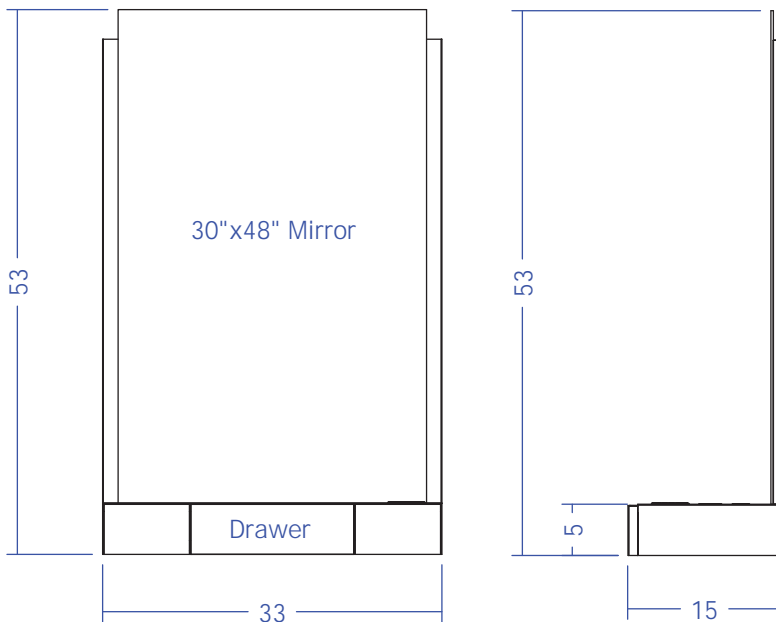

**Part #:** 3506-36  
**Description:** Cameo 36" Wall-Mounted Styling Station

**Standard Features:**

- 1 wide full extension drawer
- Countertop holders for blow dryer, flat iron, & curling iron
- Soft radius pull
- Mounts with french cleat
- 36" x 36" wall-mounted mirror
- 
- 
- 
- 

*Eight Color Choices: Black, Shaker Cherry, Cafelle, Fusion Maple, Limber Maple Wild Cherry, Brighton Walnut, Graphite Nebula*



*(Forty additional choices available for 10% upcharge)*

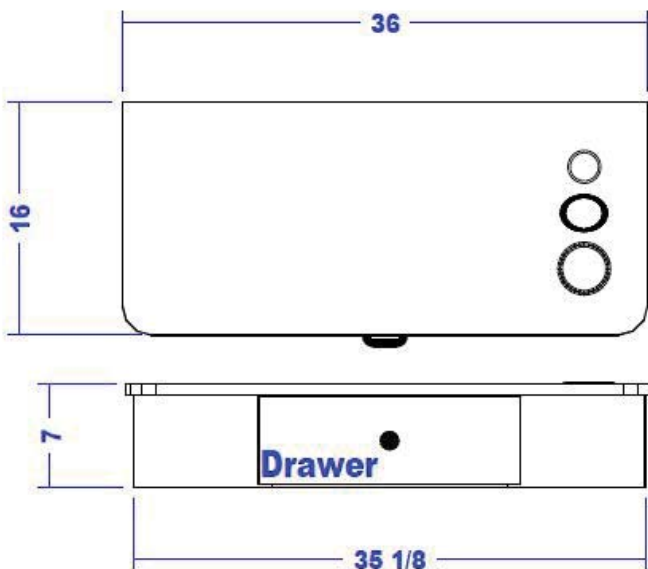

**Specifications:**

**Optional Features:**

- 
- 
- 
- 

**Shipping and Assembly/Installation Information**

Assembly Required:	<input type="checkbox"/> Yes	<input type="checkbox"/> No	
Electrical Required:	<input type="checkbox"/> Yes	<input type="checkbox"/> No	
Plumbing Required:	<input type="checkbox"/> Yes	<input type="checkbox"/> No	
Ship Dimensions	<input type="checkbox"/> "W x	<input type="checkbox"/> "D x	<input type="checkbox"/> "H
Total Ship Weight	LBS		
# of Ship Pieces	Cartons		Skids

**Additional Information:**

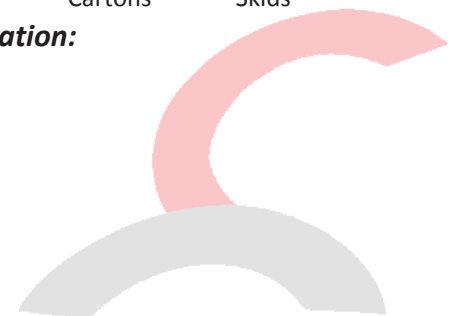



# PRODUCT SPECIFICATION SHEET

**Part #:** 3506-48

**Description:** Cameo 48" Wall-Mounted Styling Station

**Standard Features:**

- 2 Full extension drawers
- Countertop holders for blow dryer, flat iron, & curling iron
- Soft radius pulls
- Mounts with a french cleat
- 36" x 48" mirror
- 
- 
- 
- 

*Eight Color Choices: Black, Shaker Cherry, Cafelle, Fusion Maple, Limber Maple Wild Cherry, Brighton Walnut, Graphite Nebula*



*(Forty additional choices available for 10% upcharge)*

**Specifications:**

Cameo Wall-Mounted Styling Station w/ two drawers, blow dryer holder, two curling iron holders. 48"W x 15"D x 7"H. Includes 36" x 48" mirror, wall-mounted.

**Optional Features:**

- 
- 
- 
- 

**Shipping and Assembly/Installation Information**

Assembly Required:  Yes  No  
 Electrical Required:  Yes  No  
 Plumbing Required:  Yes  No  
 Ship Dimensions 32 "W x 60 "D x 42 "H  
 Total Ship Weight 142 LBS  
 # of Ship Pieces Cartons 1 Skids

**Additional Information:**

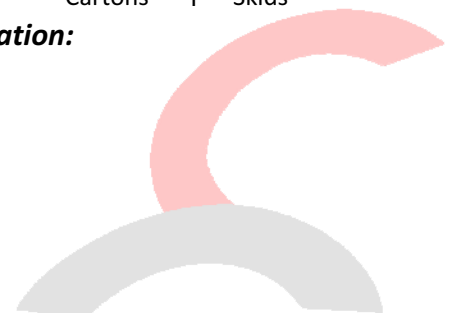



# PRODUCT SPECIFICATION SHEET

**Part #:** 5507-48

**Description:** QSE Deluxe Wall-Mounted Styling Station

**Standard Features:**

- Beautiful radius corners
- 2 full extension drawers
- Countertop holders for blowdryer, flat iron, & 2 curling iron
- Amati pulls
- Mounts w/ french cleat
- 36" X 48" Mirror
- 
- 
- 

*Eight Color Choices: Black, Shaker Cherry, Cafelle, Fusion Maple, Limber Maple Wild Cherry, Brighton Walnut, Graphite Nebula*



*(Forty additional choices available for 10% upcharge)*

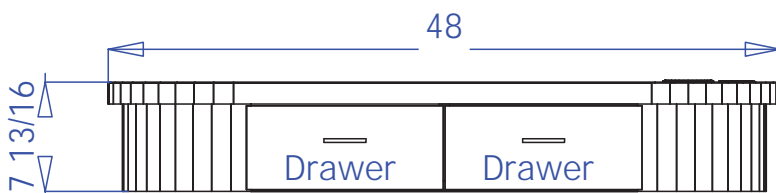
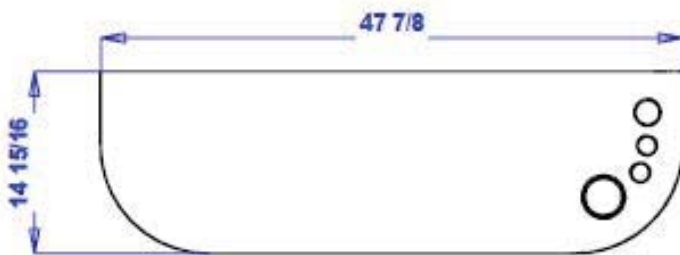

**Specifications:**

QSE DELUXE Styling Station w/ radius corners. Two drawers, blow dryer holder, flat-iron holder, two curling iron holders. 48"W x 15"D x 8"H. Includes 36" x 48" wall-mounted mirror.

**Optional Features:**

- Cam locks
- 
- 
- 

**Shipping and Assembly/Installation Information**

Assembly Required:	<input checked="" type="checkbox"/> Yes	<input type="checkbox"/> No
Electrical Required:	<input type="checkbox"/> Yes	<input checked="" type="checkbox"/> No
Plumbing Required:	<input type="checkbox"/> Yes	<input checked="" type="checkbox"/> No
Ship Dimensions	32 "W x 60 "D x 42 "H	
Total Ship Weight	148 LBS	
# of Ship Pieces	Cartons 1	Skids

**Additional Information:**

