

**Note:** A power strip is provided for each cabinet with a 4' grounded cord and (6) 15 amp outlets. Electrician is to cut outlet hole for cord and provide power supply.

STEP 2. Mount cabinets to the base by screwing (4) 1 1/4" wood screws up through cleats on base into cabinets. Then fasten the cabinets together with (4) 1 1/4" connector bolts through interior of cabinet at each corner.

STEP 1. Set base in final location.

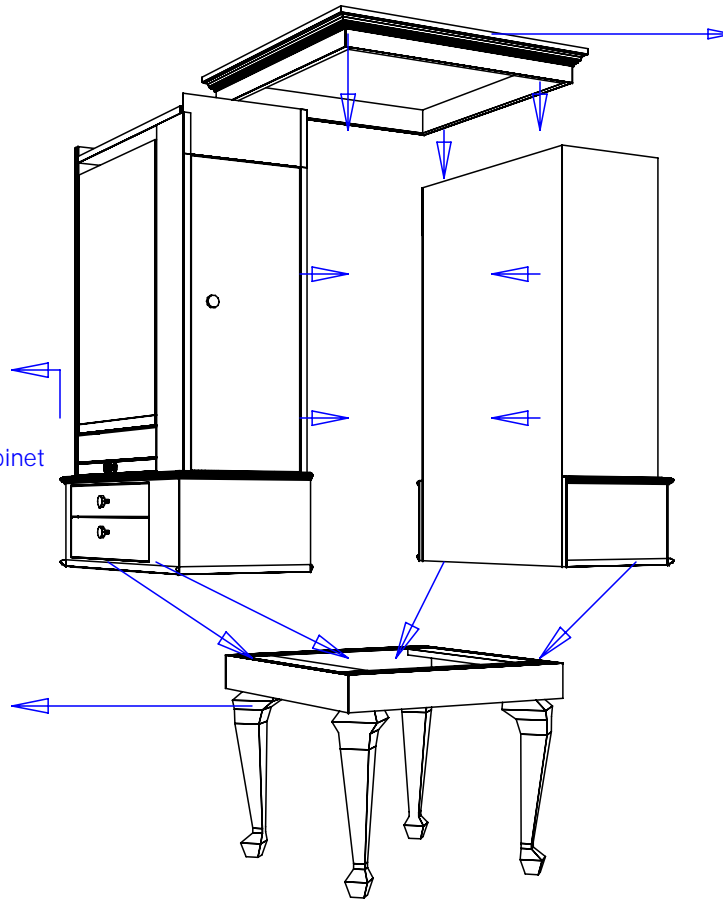

STEP 3. Place crown cap on top of cabinets and fasten using (4) 1 1/2" wood screws in each corner. Screw down through cap into cabinets.

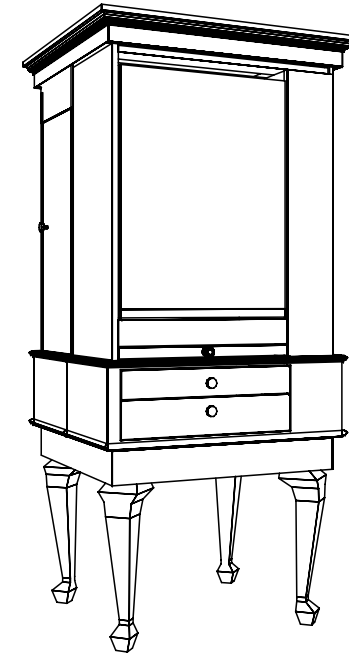

Quantity -

Finish Schedule - 881-34-1

Face Color -  
 Top Color -  
 Toe Color - (Specify)  
 Pulls -  
 Interior - Black  
 Other (Specify) -

**Installation Notes:**

1. All hardware needed for assembly is included.
2. Large items are preassembled at the factory to ensure proper alignment. Items are then disassembled into manageable sections for shipping purposes and ease of reassembly.
3. Shipping cleats need to be removed before installation. These cleats are installed to prevent damage.

**Collins** Collins Manufacturing  
 2000 Bowser Rd.  
 Cookeville TN 38506

Title:		
Size:	#: 881-34	Drawn By:
Date: 09/14/06	Sheet #: 8	