

MILLENNIA CLASSIC

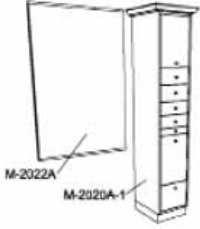

M-2020A -1

Classic styling unit (shown with M-2022A mirror, not included) contains an upper storage area with an adjustable shelf and door, six drawers, a tool compartment with a T type 3 tool holder and four-way 20 amp electrical outlet. Specify standard laminate and drawer/door pull style. Specify stain color: natural, maple, pear, cherry or black.

20"W x 82"H x 20.5"D (Includes crown)

Approximate weight: 260 lbs

M-2020A -1F

Same as above with finished back and crown for free standing application.

See page... for drawer options.

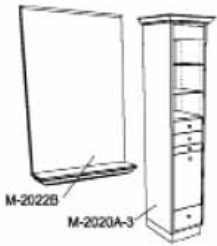

M-2020A -3

Classic styling unit (shown with M-2022B mirror, not included) contains an upper retail area with two adjustable shelves, four drawers, a tool compartment with a T type 3 tool holder and four-way 20 amp electrical outlet. Specify standard laminate and drawer/door pull style. Specify stain color: natural, maple, pear, cherry or black.

20"W x 82"H x 20.5"D (Includes crown)

Approximate weight: 250 lbs

P77172

Recessed light fixture only over display.

Maximum 40 watts (high intensity bulb included)

P73759

Glass shelves (2)

See page... for drawer options.

MILLENNIA CLASSIC

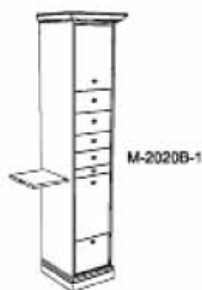

M-2020B -1

Classic styling unit contains an upper retail area with an adjustable shelf and door, six drawers, a pull-out shelf, a tool compartment with a Type 3 tool holder and four-way 20 amp electrical outlet. Decorative molding surrounds bottom of unit. Specify standard laminate and drawer/door pull style. Specify stain color: natural, maple, pear, cherry or black.

20"W x 82"H x 20.5"D (Includes crown)

Approximate weight: 270 lbs

See page... for drawer options.

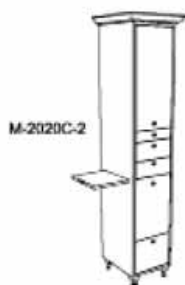

M-2020C -2

Classic styling unit contains an upper retail area with two adjustable shelves and door, four drawers, a pull-out shelf, a tool compartment with a Type 3 tool holder and four-way 20 amp electrical outlet. Four classic Queen Anne legs support the unit. Specify standard laminate and drawer/door pull style. Specify stain color: natural, maple, pear, cherry or black.

20"W x 82"H x 20.5"D (Includes crown)

Approximate weight: 260 lbs

See page... for drawer options.

M-2021

Panel for back-to-back arrangement of towers. Specify laminate.

54"W x 79.75"H x 4.5"D

Approximate weight: 90 lbs



M-2020A -3BK

Classic back-to-back styling unit including crown, base, and fluted moldings with rosette accents. Includes two curved glass shelves supported by wood brackets to match moldings and two mirrors. Each side contains upper retail area with two adjustable shelves, four drawers, tool compartment with a Type 3 tool holder and a four-way 20 amp outlet. Specify standard laminate and drawer/door pull style. Specify stain color: natural, maple, pear, cherry or black.

21"W x 82"H x 41"D (Includes crown)

Mirrors are 30" x 40"

Approximate weight: 650 lbs

MILLENNIA CLASSIC

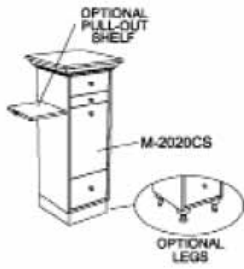

M-2020CS

Classic styling unit contains three drawers, a tool compartment with a Type 3 tool holder and four -way 20 amp electrical outlet. Specify standard laminate and drawer/door pull style. Specify stain color: natural, maple, pear, cherry or black.

19.5"W x 52.5"H x 20.25"D (Includes crown)

Approximate weight: 120 lbs

M-2022A



M-2022A

Classic series wall hung mirror with top and bottom trim. Specify standard laminate and drawer/door pull style. Specify stain color: natural, maple, pear, cherry or black.

30"W x 47.5"H x 1.5"D (Includes crown)

Approximate weight: 76 lbs



M-2022B

Classic series wall hung mirror with top trim and bottom shelf with glass top. Specify standard laminate and drawer/door pull style. Specify stain color: natural, maple, pear, cherry or black.

30"W x 49.75"H x 9"D (Includes crown)

Approximate weight: 78 lbs

M-2022BS

Shelf only.

30"W x 9"D

Approximate weight: 20 lbs

MILLENNIA CLASSIC



M-2023-42

Classic shampoo station with upper storage area and three doors. The lower cabinet has a towel drop and tilt out door with hamper . Will accommodate all Marble Products wall hung bowls (bowl not included). Specify standard laminate and drawer/door pull style. Specify stain color: natural, maple, pear , cherry or black.

42"W x 82"H x 12"D (Includes crown)

Approximate weight: 225 lbs

M-2023-45

Same as M-2023-42 except 45" in width.

Approximate weight: 250 lbs

M-2023-48

Same as M-2023-42 except 48" in width.

Approximate weight: 280 lbs



M-2024-42

Classic shampoo wall storage with upper storage area and three doors. The lower cabinet has two tilt out doors with hampers and a center door with an adjustable shelf . Will accommodate all Marble Products wall hung bowls (bowl not included). Specify standard laminate and drawer/door pull style. Specify stain color: natural, maple, pear , cherry or black.

42"W x 82"H x 15"D (Includes crown)

Approximate weight: 225 lbs

M-2024-45

Same as M-2024-42 except 45" in width.

Approximate weight: 250 lbs

M-2024-48

Same as M-2024-42 except 48" in width.

Approximate weight: 280 lbs

MILLENNIA CLASSIC



M-2026

Classic reception desk with (2) drawers and (2) file drawers on left and right side cabinets supported by classic Queen Anne legs. Includes wire grommet. Specify standard laminate and drawer/door pull style. Specify stain color: natural, maple, pear , cherry or black.

80"W x 42"H x 30"D

Approximate weight: 400 lbs

For A.D.A. shelf applications contact our nearest showroom



M-2027

Classic retail unit with (3) adjustable laminated shelves with full back and lower storage area with two doors. Specify standard laminate and drawer/door pull style. Specify stain color: natural, maple, pear , cherry or black.

36"W x 82"H x 15.75"D

Approximate weight: 190 lbs

(Specify finished right or left when used with M-2027A or 2027B)

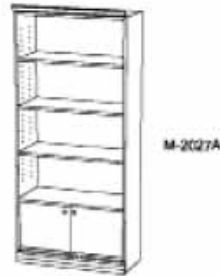

M-2027A

Add-on unit same as M-2027 except without molding at top and bottom of sides.

(Specify left or right handed application)