

VICHY SHOWER INSTALLATION INSTRUCTIONS

HYDRO-KINETIC VICHY SHOWER PARTS LIST

Inspect the packaging to ensure you have received all the parts needed for the installation. Note: Handheld Shower is packed inside white Shower Box.

Stainless Steel Rainbar 	Stainless Steel Wall Mount Bracket 	Valve Assembly & Cover 
Hand Shower 	Flexible Hand Shower Hose 	Hand Shower Holder Bracket 
(8) Showerheads with Shutoff Valve 	White Hose and Clamps 	

VICHY SHOWER INSTALLATION INSTRUCTIONS

OPTIONAL EQUIPMENT PARTS DESCRIPTIONS:

Extra Handheld Shower Additional Parts

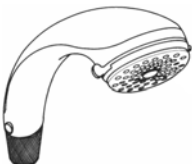
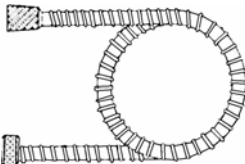
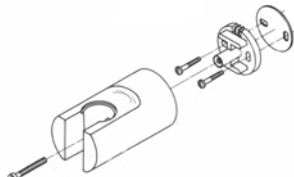
<p>Additional Handheld Shower</p> 	<p>Flexible Hand Shower Hose</p> 	<p>Hand Shower Holder Bracket</p> 
---	--	---

INSTALLATION FOREWORD

The TouchAmerica Hydro-Kinetic Vichy Shower should be installed by a qualified technician, experienced and licensed in plumbing connections and structural assemblies. These instructions are intended to act as a guide to installing the Vichy Shower but may not cover all plumbing and structural configurations encountered. Be sure to comply with all building codes in your area.

Tools required for installation:

- Adjustable Crescent[®] wrench
- Phillips screwdriver
- Sockets or wrench to fit mounting bolts
- Teflon plumbers tape
- Power drill
- Corrosion-resistant mounting hardware
 (1/4" S.S. lag bolts recommended, depending on wall type)

VICHY SHOWER INSTALLATION INSTRUCTIONS

ROOM AND PLUMBING PREPARATION

- **WALLS** - The TouchAmerica Hydro-Kinetic Vichy Shower weighs approximately 45 lbs. total, but because of the torque generated by the long lever arm created by the long Rainbar, the wall needs to be reinforced. This will insure that the equipment does not collapse on a client during a treatment, once the equipment is in use. Wall studs with properly anchored wood blocking, masonry walls or steel columns are examples of acceptable mounting structures. See the Vichy Shower Elevation Rough-in (included with this packet of information) for blocking locations. Do not attach Rainbar to unsupported sheet rock or tile wall. Mounting to metal studs is not recommended, unless special provisions are made to reinforce the wall. All local building and fire codes must be considered when installing the Vichy Shower. The walls are recommended to be tiled to at least a level of 4'-0" above the finish floor. If a tiled finish is not desired, another finish may be used, as long as it is waterproof.
- **FLOORS** - The floor should be tiled. If a tiled finish is not desired, another finish may be used as long as it is waterproof. The floor must be pitched towards a floor drain. A minimum 3" diameter drain line is recommended for this drain since the Vichy Shower uses 15 G.P.M. when in use. Be sure to account for 'mud' build-ups for floor pitch when locating water supply line heights. Please note that this unit is used approximately 20 min/hr during a normal service and cleanup cycle.
- **WATER HEATER** – The Vichy Shower requires approximately 150 gallons of 140° F water per hour when mixed with 140 gallons 58° F water to produce a total volume of 290 G.P.H. of 104° F water usage, when at full capacity. Your water heater is required to be high recovery. Gas-fired heaters or boiler systems have a faster recovery and are recommended, however, your plumber, architect and/or mechanical contractors should make the final decisions for selecting the proper sized water heater for your particular situation.
- **CEILING** - The ceiling is recommended to be a minimum of 8'-0" A.F.F. The ceiling does not have to be waterproof. It is recommended that it be water resistant due to the probability of water being deflected towards the ceiling during wet services.

VICHY SHOWER INSTALLATION INSTRUCTIONS

- HVAC - An exhaust fan (as quiet as possible) is recommended to remove the moist air from the room without returning it to the main air supply system. It is recommended that this room be 'zoned' separately when possible. Clients in wet areas tend to get colder due to the evaporation of water from the surface of their skin, as opposed to dry clients in other types of service rooms. When zoning is not possible or affordable, a separate waterproof electric baseboard or wall-mounted radiant heat panel is suggested.

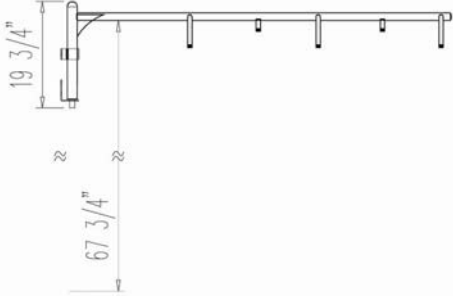
	<p>Determine mounting location of Rainbar and Valve Assembly. Recommended mounting height of the Rainbar is 30" above the height of the table to be used with the Vichy Shower. Dimensions indicated assume use of TouchAmerica Wet Tables. <i>See the Vichy Shower Elevation Rough-in (included in this information packet) for blocking heights.</i> Valve Assembly can be mounted on either side of the Rainbar, depending upon room orientation. Rough-in Drawing only indicates left-hand mounting position.</p>
<p>See Rough-in Drawing</p>	<p>$\frac{3}{4}$" hot and cold supply lines should be located per dimensions shown in the Vichy Shower Elevation Rough-in (included with this packet of information). The Valve Assembly's standard mounting position is to either side of the Rainbar and attached to the Rainbar with a flexible hose.</p>

VICHY SHOWER INSTALLATION INSTRUCTIONS

MOUNTING THE RAINBAR

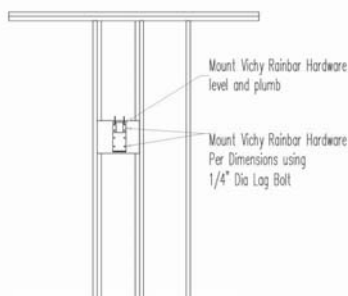
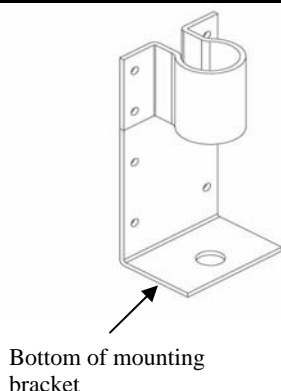

Position the stainless steel mounting bracket on the surface it is to be attached to, according to the diagram, and mark mounting holes. The flange with the large hole is the bottom of the bracket and goes towards the floor.

IMPORTANT – The wall and fasteners to which the Vichy Shower is attached must be able to support a rotational load of 900 lbs. Mounting the unit to metal studs is not recommend. Always consult local building codes.

Use a level to align mounting bracket so that the top and bottom flanges of the bracket are level. This is to keep the Rainbar from swinging to an unwanted position on its own. Attach the mounting bracket using appropriate fasteners and washers for the surface to be used. TouchAmerica does not provide the fasteners needed to attach the bracket because of the variety of wall types that might be encountered. Stainless steel hardware is strongly recommended to prevent rusting. Use all 8 mounting holes on the bracket to insure the Rainbar does not fall on the client during use. *Note: To mount Rainbar at height other than height recommended in the specifications, it is necessary to verify the distance between the Valve Assembly and Rainbar, the distance between Rainbar and Wet Table work surface, and the distance from the Rainbar to the ceiling.

VICHY SHOWER INSTALLATION INSTRUCTIONS

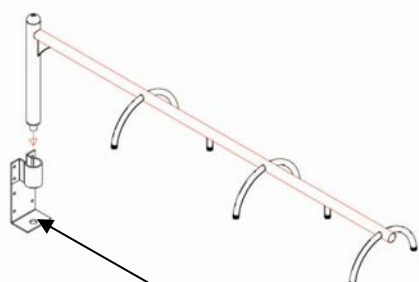

Insert large plastic washer between bottom of Rainbar and bottom of mounting bracket

Once mounting bracket is securely mounted to wall, insert the Rainbar, as shown. Slide the bottom of the Rainbar stem through the top opening. Place large plastic washer over the $\frac{3}{4}$ " nipple on bottom of Rainbar stem and insert nipple into the hole at bottom of mounting hardware.

Check the Rainbar for strength to insure it is securely attached to the wall. The Rainbar should swing easily, yet remain in place wherever it is released. If it does not remain in place, check the mounting bracket to insure it is mounted plumb.

VICHY SHOWER INSTALLATION INSTRUCTIONS

MOUNTING THE VALVE ASSEMBLY



The Valve Assembly mounts to either side of the Rainbar, depending upon room orientation. The cold and hot water supplies should be positioned to enter the Valve Assembly through the holes provided in the back plate.

*Note: If there is an existing plumbing rough-in, and it is different from the Vichy Shower Elevation Rough-in (included with this packet of information), new holes can easily be drilled into the back plate as long as no pipes interfere with the internal parts of the Valve Assembly. Standard wood-working drills or saws can be used.

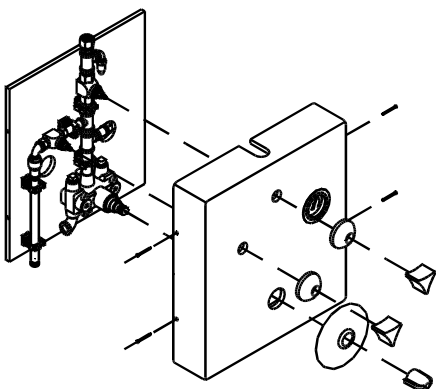

Remove the four screws that connect the cover of the Valve Assembly to the back plate, and remove the cover. The valve handles and their escutcheon must be removed prior to removing the cover. See separate picture illustration for instructions to remove control valve knobs and temperature control valve, and release the escutcheon.

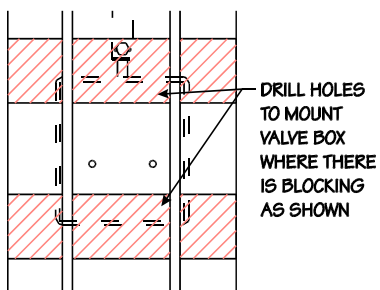

The back plate must also have holes drilled for mounting the Valve Assembly to the wall. Determine the appropriate location for the mounting holes and drill holes in the back plate. Attach the Valve Assembly to the wall.

VICHY SHOWER INSTALLATION INSTRUCTIONS

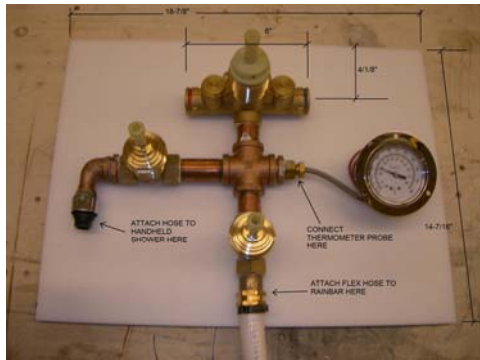
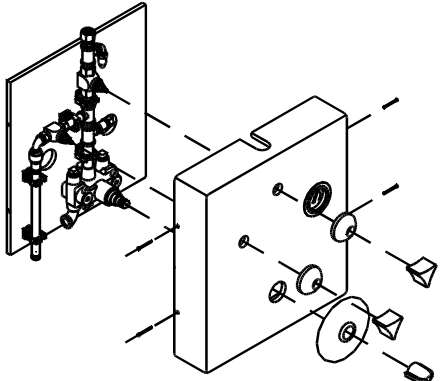
	<p>Connect the hot and cold water supplies to the thermostatic valve. The hot water supply must hook to the left side of the valve (as you face the valve mounted to the wall). Many methods may be used to connect the supply lines to the Valve Assembly. Use the best method for your location and local building code. Care must be taken to avoid reducing full water flow. Attach the flexible hand shower hose to the 1/2" nipple at the bottom of the valve assembly.</p>
<p>Attach thermometer probe</p>	<p>Attach thermometer to the Valve Assembly by inserting the thermometer sensor into the thermometer seat, and tighten ferrule nut on sensor.</p>
	<p>Connect white flexible hose coming from bottom of Valve Assembly to nipple on the bottom of Rainbar. Secure with clamp provided. Mount the small white acrylic cover over the Rainbar mounting hardware.</p>
	<p>After restoring water pressure to the Valve Assembly, check the connection for leaks, replace the cover, and attach it to the back plate with the four stainless steel screws provided. Replace escutcheon and valve handles.</p>

VICHY SHOWER INSTALLATION INSTRUCTIONS

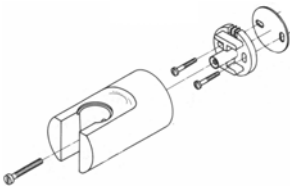
	<p>Attach the hand shower to the hose.</p>
	<p>Identify a convenient location to mount the hand shower, and install the hand shower mounting bracket.</p>
<p>Adjust thermostatic mixing valve</p>	<p>Once the system is operational, it may be necessary to adjust the knob position on the thermostatic mixing valve, so that the temperature dial is properly calibrated to the correct temperature. See the instructions for temperature calibration in the valve manufacturer's instruction sheet.</p>

VICHY SHOWER INSTALLATION INSTRUCTIONS

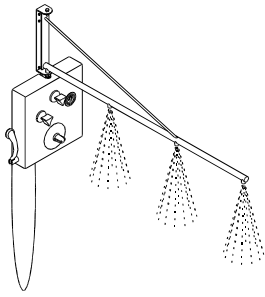
	<p>Before attaching showerheads, it is important to run the shower for 5 minutes to remove trash from water lines. Failure to flush lines will result in clogged showerheads.</p>
	<p>Screw the eight showerhead/shutoff valve assemblies onto the ½" nipples on the Rainbar.</p>

The Hydro-Kinetic Vichy Shower is now ready for use.



VICHY SHOWER INSTALLATION INSTRUCTIONS

REMOVING VALVE BOX COVER

1.



2.



3.



4.



5.



6.



VICHY SHOWER INSTALLATION INSTRUCTIONS

REMOVING VALVE BOX COVER

7.



8.



9. Remove screws that connect the valve box cover to the back plate. There is no need to remove the thermometer. Cover can now be released from back plate.

10. See manufacturer's instructions enclosed for valve adjustment and care.